

THE Bradford Bridge

COMMUNITY NEWS FOR NEIGHBORS BY NEIGHBORS

Volume 26, Number 10

October 2015



Thoughts on Autumn in Bradford



If you go up Rowe Mountain Road, you will see where our town began. The 1838 Bradford Center Meetinghouse and the school are still there. In the cemetery behind granite posts are the fading etched stones of some of Bradford's early settlers. New flags mark a few of the graves in the old cemetery. These mark the burial place of Revolutionary War veterans.

Some last names are still familiar and these descendants can be found carried into a 20th Century memorial of the last two wars at 75 West Main Street. Behind that memorial is our Town Hall which once formed the trio of public buildings on Rowe Mountain.

Through the centuries, the town has evolved from an agricultural community, moved into the industrial age with its mills, shops and railroad, and is now home to people with a wide variety of occupations and interests.

There is much that Bradford can be proud of: a distinguished library, active church and community center, a tradition of Town Meeting, an excellent school, and supportive organizations that contribute to the well-being of the town and its people.

Physically, it embodies many of the elements that exemplify New Hampshire. There are lakes, rivers, rolling hills, dramatic rock formations, a covered bridge, and fine examples of American building design and architecture. The Town Hall at 75 West Main Street is one of these. Built in 1797 as a meetinghouse, it was part of the original trio on the hill. It was moved to its present location about 60 years later during the Civil War when the meetinghouse became the upper story and a school was built on the ground floor.

This building (our Town Hall) forms a unique link to the beginnings of Bradford. Those who built the town fought for their country and were the foundation of the community we cherish. Town Hall's preservation relies on public spirited people to work and plan in harmony.

Trip to Japan by Phyllis Wilcox

This month instead of 10 questions we interviewed Meg Fearnley, Bradford's librarian, who had a recent two week trip to Japan to see her son Glenn, who is teaching English in a Japanese town. Since I believe that many of us here in Bradford will not visit Japan we can share Meg's impressions of a tiny Japanese town without the 13 and one half hour trip across the ocean.

I have some connection to the area in a distant way. When I was growing up my father traveled to Japan, China, and Hong Kong and brought home mementos from the area. Many years ago what has become almost commonplace travel for some people is still not part of life for everyone so for a change of pace we will get Meg's impression of her visit.

Japan was not what I expected. I thought of it as being very modern and cutting edge but it wasn't that way at all. I visited Maizuru, which is a small port city on the Sea of Japan. I was expecting everything modern and up to date and it was quite the opposite. The plan was to visit with my son and see Japan. He was on summer holiday from

(continued on pg 3)

(continued on pg 8)

The Bradford Bridge



P.O. Box 463
Bradford, NH 03221
Ph.: 603-938-2692
contact.us@bradfordbridge.com

VOLUNTEER STAFF

AUDREY SYLVESTER, CHAIR

Beth Rodd, Marcia Keller, Editors,
Maureen O'Keefe, Treasurer, Ad Rep
Marion Hall, Subscriptions & Distribution
Nola Jordan, Distribution
Carey Rodd, Sandy Richard, Layout

ADVISORY BOARD

Harriett Douglass, Marion Hall, Mary
Keegan-Dayton, Marcia Keller, Beth Rodd,
Audrey V. Sylvester, Phyllis Wilcox
Printed by RC Brayshaw & Co., Inc.

Subscription Information

To receive The Bridge by mail, please send a \$25 check to cover mailing costs to the above address.

Advertising

The Bradford Bridge is a free community newspaper supported by advertisers. To place an ad, call Maureen O'Keefe at 938-2941. The firm deadline for all ads and articles is the 20th of the month.

Submissions

The Bradford Bridge is written by neighbors, for neighbors. Anyone is welcome to submit articles and/or photographs of interest to the community. We reserve the right to edit submissions.

From the Editor

We lit our first wood stove fire today, the first time this year, to ward off an early morning chill. There is something reassuring and familiar about this season of changing leaves, wool sweaters and crisp early morning air. School buses trundle along, the days are shorter and we are preparing to hunker down for the coming winter season of holidays, skiing, and time to reunite with families.

Audrey Sylvester has written a thoughtful piece on living in Bradford, inspired in part by a visiting friend who viewed our town with fresh eyes. Main Street is looking snazzy as improvements by many volunteers add sparkle to the scene. The Historical Society is in the midst of making our public buildings accessible, an ice skating rink is being planned by Parks & Rec and efforts to restore our Town Hall continue to engage the community. On Saturday, October 3, the Town Hall Restoration Committee will present an updated report on the building at the BML, 9am to noon. A presentation by TDS, same date and time, will also be held at Town Hall. Come on down and find out what's current in technology and historic preservation.

Thanks to all of our readers and advertisers for your continued support of the Bradford Bridge.

Beth Rodd,
October Editor



Selectmen's Office Hours 938-5900

Mon - Thurs: 7:30 am - 5:00 pm
Friday: 7:30 am - noon
Selectmen meet every other
Monday from 5:30 pm - 7:30 PM
until further notice
Special Meetings will be posted
24 hours in advance

Town Clerk/ Tax Collector
Office Hours
938-2288

Monday: noon-7:00 pm
Tuesday: 7:00 am-11:30 am
12:30 pm-5:00 pm
Friday: 8:00 am-11:30 am and
12:30 pm-5:00 PM
Saturday: (2nd & 4th) 9-Noon

Planning Board Circuit Rider
Wednesday
call 938-5193 for appointment

Town offices are temporarily
located at BACC



Bubba's Catering is available for all occasions! 603-763-3290
976, Rt 103, Newbury, NH
bubbahmplt@tds.net bubbasbarandgrille.com

We may no longer be called Cobble Pond but
OUR FABULOUS INDIAN FOOD is still here! TAKE OUT
ON WEDNESDAY AND FRIDAY

Bradford Market

Groceries - Indian Spices & Indian and Take-out Dishes - ATM -
Beer & Wine Lottery Tickets - Gifts - Sodas - Snacks - Copy Ma-
chine - Coffee - Sandwiches - Auto Supplies - Toys - Magazines
& Newspapers - Video Rentals

OPEN SEVEN DAYS - 6 am- 10 pm

Route 103 938-2662 Bradford, N.H.



Town Hall Restoration Oversight Committee Update

There has been an update on the discussions with LCHIP and a letter and plans had been forwarded to L-chip officials regarding the scope of project change. They have received correspondence requesting a letter from our structural engineer with his opinion on the need for a full foundation. The LCHIP review board will meet on Sept 28th.

The committee plans to prepare requests for proposals for the full foundation, sprinkler system and heating system. The subcommittee will wait until the full foundation plan is approved by LCHIP before requesting proposal

RHC and Fundraising Committee chairman reported on the successful fund raising event held on August 29th. All attendees at the event contributed to the Cornerstone Account. In the past 4 weeks, \$24,125 has been raised bringing the balance in the Town Hall Cornerstone account to \$39,632.53. The Town Hall Renovation Trust Account has a current balance of \$8,989.15 (two additional checks totaling \$100 were received this week and will be deposited in the Trust Fund.) In addition the RHC has spent just under \$2,000 in mailing expenses.

The Hunt Grant for elevator/ADA accessibility – will be written for the next grant round

(March 2016) to insure the approval of the full basement. This is needed to determine the type of elevator needed and amount of money to be requested. Kelly Gale mentioned the need for a second lift required to access the stage.

The committee discussed the next step in the process. John Greenwood raised the question of how to get voters out to the polls. Personally contacting neighbors and offering rides was discussed. Topic to continue. Questions on approaching the Budget Committee led to discussion on the need for firm estimates for the heating, foundation and sprinkler systems.

Autumn (cont from pg 1)

Wednesday, November 11 is Veteran's Day. The Town of Bradford would do well to think of the founders of our town and be grateful to all veterans for their service to our country. And, never forget the people, buildings and historic monuments that serve as a reminder of Bradford's place in American history.

While the weather stays fine and before the November winds blow, take a few minutes to visit the old town center, visit the gravesites of our town ancestors and reflect on Bradford's history, the buildings and people who hold our rich past. Say hello to a veteran this month and thank them for their service.

www.tallpinesnh.com
938-2366

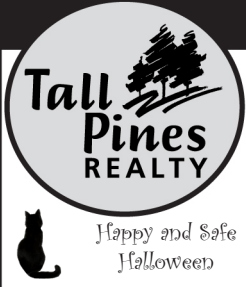

Ann C. Hallahan,
Broker/Owner
Laura Hallahan
Holly Salera
Laura Squires



MULTI-FAMILY COLONIAL
Main house plus apartment,
walk to school
Bradford \$199,000



RESTORED FARMHOUSE
Country charm, studio &
garage/barn, pristine
Washington \$219,000
1 Center Road, , P.O. Box 525
Bradford, NH 03221 603-938-2366
Located by the Bement Covered Bridge since 1988!

LUMBER BARN.com

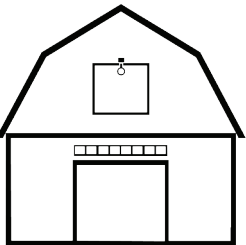

Bradford
(603) 938-5161

Goshen
(603) 863-5601

Power Barn
(603) 938-2000

BEHIND EVERY PROJECT IS A
True Value

Selectmen's Highlights

Dave Gaudes, on behalf of the Lake Massasecum Improvement Association, thanked the Selectmen for their support. He said both the Lake Host program and "Adopt a Highway" program were successful. The milfoil was treated twice in 2014 and 164 gallons of milfoil were removed from the lake. In 2015 no treatments were necessary and only 54.875 gallons were found and removed.

Dave Eckman of Eckman Engineering discussed the QBS (Qualified Based Selection) process for bridge repair work, which can be followed without going through the State Bridge Aid Program. He has a plan to repair the Water St Bridge within a 2 week time frame. Selectmen asked several questions and thanked him for his time. Selectmen appointed Kevin Faria as a Bradford Police Officer. Review of Naughton contract is contractually scheduled for November. Selectmen expressed their happiness with current services provided.

Selectmen voted to reestablish the Highway Safety Committee with representatives from the Fire, Highway, and Police Departments and Board of Selectmen. This is required in order to apply for Highway Safety grants.

Personnel evaluations will be conducted before the end of the year.

Public Hearing for Breezy Hill Rd Layout scheduled for September 28, 2015 at 5:30pm

Donation for the Town Hall of \$75 was received and accepted by Selectmen.

Autocraft Update: Chair advised that Wilcox is currently in jail and while the Selectmen are still unhappy with what is on Rte. 114 they cannot enforce under the circumstances.

Next Meeting: There will be no meeting on October 12th Columbus Day. Check bradfordnh.org. for the rescheduled date.

Minutes of all meetings are on file at the Town Office and online at bradfordnh.org.

Planning Board Notes

Subdivision Regulations Following a public hearing, the Section VII. D. Boundary Markers was amended to add "Where drill holes are used, they must be a minimum of one inch deep and 1/2 inch in diameter and have an iron pin or other magnetic metal in the drill hole ad be at least one inch in length."

Boundary Adjustment was approved for Map 6 Lot 120 on Marshall Hill Road.

Site Plan Revision approved for Map 3 Lot 82 B to allow construction of an additional storage building on Breezy Hill Road.

Master Plan Michael Tardiff, Director of Central new Hampshire Regional Planning Commission (CNHRPC) discussed several approaches to consider for preparing the initial survey

and getting the word out to the public.

CIP The Board reviewed changes to the draft report and discussed the public hearing to be held on Tuesday October 13 at 7:00 PM. Copies of the report will be available by October 2nd at the Town Office during regular business hours, at Brown Memorial Library and online at bradfordnh.org.

Minutes of all meetings are on file at the Town Office and online at bradfordnh.org.

| Bradford Bridge Advertising Rates | |
|--|----------|
| Basic rate is \$8.00 /column inch One column inch (2 3/8" wide) | |
| x 1" high | \$8.00 |
| x 2" | \$16.00 |
| x 6" | \$48.00 |
| Two column inches (4 7/8" wide) | |
| x 1" high | \$16.00 |
| x 2" high | \$32.00 |
| x 3" | \$48.00 |
| x 8.5" | \$96.00 |
| 1/2 Page | \$120.00 |
| Full Page | \$240.00 |
| Other ad sizes as designed will be prorated | |
| Notes: 10% discount allowed for local non-profits, paid-in-advance and 12 month ads. | |
| Political ads must be pre-paid | |
| Ad copy should be sent in PDF format by the 20th (firm) of each month to: contact.us@bradfordbridge.com | |

EPA Certified for Lead
ALBERT L. LEBLANC
938-2018
 INTERIOR & EXTERIOR PAINTING
 REMODELING • CARPENTRY • DRYWALL
 REFINISHING • KITCHEN & BATH
 "fully insured, free quotes"

Alert to Advertisers

To ensure that your ad is printed as you (and The Bradford Bridge) wants it to appear, it must be submitted in "press quality" PDF format, at least 300 pixels per inch (ppi). The Bridge cannot be responsible for the reproduction of your ad if this format is not provided. Also, keep in mind that trying to fit too much text in a small ad can lead to less than satisfactory results. Firm deadline is the 20th of the month.

Your understanding and help in this matter is appreciated.



Happy Harvesting

Bement Bridge Scoping Meeting

A group of volunteers are discussing the Bement Bridge Rehabilitation Project. A State DOC rep briefly explained the state's bridge replacement process. Review of the Project Cost Detail Report, which was based on estimates done approximately 4 years ago, indicates that about half of the project's cost is in abutment repair. An agreement will be signed in the next few weeks and forwarded to the committee by the DOC rep. In the meantime DOC recommends that the town sketch out an anticipated timeline. Planning funds will be moved to 2016 and construction funds to 2017.

Progress reports will need to be submitted during the 3 year building period to keep the state abreast of the progress of the project.

Minutes of all meetings are on file at the Town Office and online at bradfordnh.org.



Gift Certificates available

Open Tues.- Sat.
10am - 5 pm

*We're so much more than a frame shop...
come in and see what's new.*

**Framing ~ Art ~ Prints ~ Pottery ~ Antiques
Furniture making and repair**

916 Main Street, Fountain Sq., Contoocook • 746-4996
coveredbridgegallery@conknet.com

NOTICE

The subscription price of The Bradford Bridge will be raised for 12 issues from \$20 to \$25 per year due to the cost of stamps and envelopes. The increase will be effective when you renew your annual subscription.



14 Flavors of Premium Ice Cream



Slices available all day

Delicious Pizza!



Dine in, call ahead, or get it **DELIVERED!**
Appetizers, Subs, Salads, Dinners and more!

(603) 938-2600

Daily Lunch Specials!

Located at the corner of Rte. 103 & Main - Bradford, NH

Get in Step with Improvements on Bradford's Main Street

Last month's Bradford Bridge made note of the recent improvements on East Main Street, improvements to which the Bradford Historical Society has been proud to contribute.

The Society plans to go further. Prompted by the need to provide handicapped access to its public spaces, as required by law, we have completed master planning for the site on East Main Street. The process of determining how best to achieve handicapped access led us, however, to conclude that the building most suitable for compliance with ADA regulations is not the Tin Shop, as we originally envisioned, but the recently relocated Post Office. The Post Office is

not only more suitable for handicapped requirements (parking, ramps, and restrooms), but also, being larger than the Tin Shop, it promises to better serve as a meeting space.

street parking is envisioned, since parking near the Tin Shop is chancy at best. The Tin Shop will continue to house our historical exhibits and photo collections. During the winter months, call 938-2078 for an appointment to study our community's past. And look for publicity about our upcoming events.

This project is ambitious, as well as costly. Grant proposals have already been submitted to foundations, but needless to say proposals alone provide no guarantee. Moreover, many of

the grant proposals ask for evidence of community support.

For that reason, as we alert the Bradford community of our plans, we call attention to our intentions to solicit contributions. Gradually, thanks to the efforts of various organizations, as well as numerous volunteers and benefactors, Main Street is returning Bradford to a measure of its former glory.

Join us for the BHS Annual Meeting Wed. Oct. 28th at 7pm at the Tin Shop! Refreshments will be served. All are welcome.

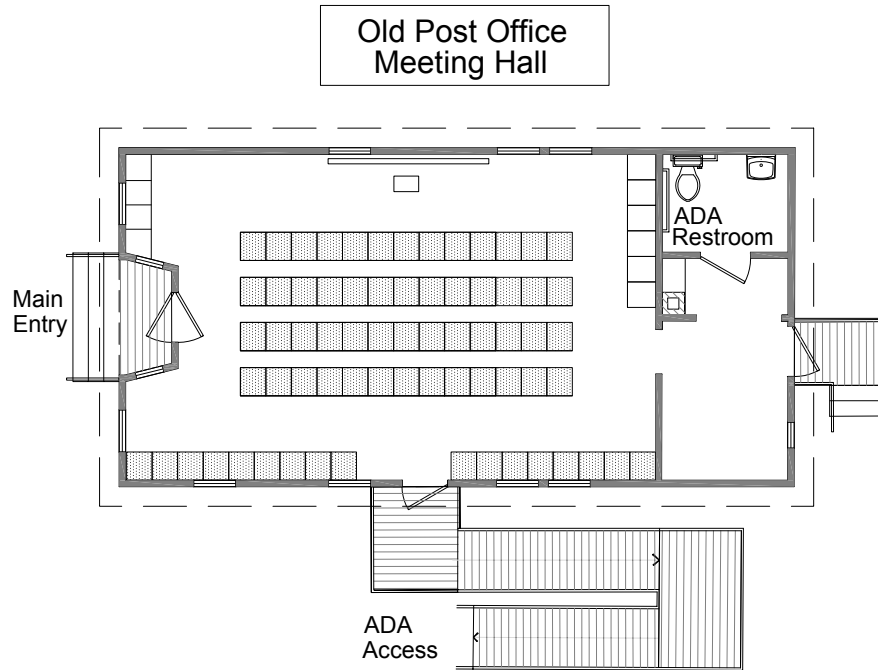

See here our proposed plan. The Post Office will be turned and sited on a concrete pad, and ultimately will be linked by access pathways to other buildings on the site. In addition, off

NEWBURY PALACE PIZZA HOURS

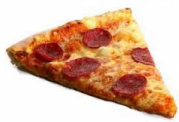

Sunday - Thursday 10 a.m. - 9 p.m.
Friday - Saturday 10 a.m. - 10 p.m.

104 Route 103
Newbury, N.H.
Next to the Rolling Pin
Gift Certificates Available

938-5050

We deliver!



* Enjoy ice cream and meals on the deck *

Come and see the BEST PRICES in the AREA

Hugo's Electric, Inc.

Licensed & Insured

RESIDENTIAL • COMMERCIAL

938-5573

3191 State Rte 114, Bradford

Ausbon Sargent Conserves a 37-Acre Property in Sunapee

On August 21, 2015, Patricia Sorento of Sunapee donated the 37-acre Sorento Conservation Easement to The Ausbon Sargent Land Preservation Trust. This property is a beautiful, undeveloped mix of fields and forests with a stream that flows through the southeastern portion of the property providing a natural habitat for many woodland birds, animals, reptiles, amphibians and insects. The soils are highly ranked for forest production. There is a snowmobile trail that winds through the Sorento easement offering opportunities for low impact public recreation. The gift of the Sorento Conservation Easement is important for the many assets listed above, but its proximity to other im-

portant protected properties makes this property even more valuable. The Sorento property lies near Ausbon Sargent's Wendell Marsh easements and the NH Fish and Game's Dobles Tract, as well as the Town of Sunapee's Webb-Flint Lot and Dewey Woods Preserve. With the addition of the Sorento Conservation Easement in Sunapee, The Ausbon Sargent Land Preservation Trust now protects 136 properties covering 11,040 acres in their 12-town region.

Ausbon Sargent is a non-profit land trust whose mission is to help preserve the rural landscape of the 12 towns it serves in the Mt. Kearsarge/Lake Sunapee.

Selectmen's Meeting Schedule



October 13
(tentative; please check online for update)
October 26

COONEY ELECTRIC

FAMILY OWNED SINCE 1926

LICENSED MASTER ELECTRICIAN - NH / VT

WHEN QUALITY COUNTS
CALL COONEY!

938-2415



MainStreet BookEnds

www.mainstreetbookends.com

Store Info, Browse, Order Books & eBooks

Books and Toys

Visit MainStreet MarketPlace & Gallery
Local Art, Products, a "Third Place" to Gather & Relax

OPEN EVERY DAY 9 ~ 6
100% Solar Powered!

16 E. Main St., Warner 603-456-2700
~ Cultivate Community ~ Shop Locally ~

Check out our NEW ATM in Bradford!

You can now make envelope-free check and cash deposits at Sugar River Bank's **INTELLIGENT DEPOSIT ATM**, conveniently located in front of The Pizza Chef at 101 East Main Street, Bradford.

How can we help you?
800.562.3145 | sugarriverbank.com | Member FDIC | EQUAL HOUSING LENDER

Old Fashioned Service. Modern Healthcare.

Cindy Snay, Owner/Pharmacist

11 East Main Street
Warner, New Hampshire
603.456.3556
Mon.-Fri. 9am-6pm & Sat. 9am-1pm

Serving Bradford with a community bank tradition

Full-Service Banking • 24-Hour ATM Drive-Up • Free Online Banking and Billpay

28 offices including Main Street, Bradford
938-2277 • www.lakesunbank.com

Equal Housing Lender • Deposits Insured by the FDIC

WALKER AUTOMOTIVE

Quality < Dependable > Friendly
Automotive Service & Repair

603-526-4848
Rt. 11, Wilmot, NH
Major & Minor Repairs
Foreign & Domestic Vehicles
www.WalkerAutomotiveInc.com

Ayer & Goss

FUELS

24 HOUR SELF SERVICE GASOLINE & DIESEL PUMPS

Serving the area's heating needs for more than 60 years
FUEL OILS & LP GAS / COMPLETE HEATING SERVICE

938-5335

Route 114, Bradford • Hall Ave., Henniker . . . 428-3333

Sarah W. Chapin
Registered Pharmacist



• PO Box 718 • Henniker, NH 03242
Phone (603) 428-3456 Fax (603) 428-7793
Email: HennikerRx@aol.com

10 QUESTIONS (cont from pg 1)

the Japanese school where he is teaching Japanese children from kindergarten through sixth grade. Although I miss him, it is possible that he will remain over there for a while.



The small city where he taught was economically challenged with many businesses closed. The plane trip was long but quite pleasant. When I saw my son's apartment I was surprised by the limited space, 200 square feet or 10' by 20' which included a kitchen, bathroom, washing machine and a bed. I could see the space would be somewhat a test for our mother/son relationship but we managed. He has a job contract for one year which can be extended.

Glenn lives in a little neighborhood where the houses are very small. Every square has a building and a garden where vegetables and flowers are everywhere. It was similar to stepping back in time where the men went off to work in the morning and most of the women stayed at home and did wifely things like cooking, shopping and gardening. The summers are very hot with a norm of 98 degrees so the women planted for maximum shade. The competition for best garden was quite obvious and the goal was vegetables for the table and trees and shrubs for the cooling shade.

The neighborhood had a public address system every day at 6 pm. It was usually gentle piano music. One morning there were public announcements but since I couldn't understand Japanese and few people spoke English I didn't know what was happening.

The women in town rode bicycles for shopping and transport. Many of the women were in their eighties and remarkably fit and able to ride everywhere on their bikes. They wore old fashioned sun bonnets, long sleeves and gloves to protect their skin. Light skin is the ideal. The few young women who drove cars to work wore long gloves to protect their arms from the sun and heat. In earlier years they were a farming community but now that is over.



Fresh food is very important and the shops all had many different sorts of vegetables and huge trays of fresh fish. No one was overweight and meat was in short supply. People shop every day but the portions when compared to our country were very small size.

The landscape is very beautiful. There are Shinto Shrines everywhere. They are all shapes and

sizes but each one is lovely. The townspeople were friendly and gracious but conversation was limited due to the language barrier. There were libraries and cooling stations for those who did not have air conditioning. My son had to travel to four different schools for teaching so he had a very small car. We drove around sightseeing but when I thought we were going very fast it turned out that it was about 30 miles an hour but seemed faster since the machine was so tiny.



The largest nearby city was Kyoto but we never visited there because it was too hot. In spite of the heat in summer they do get snow during the winter months. The people pay attention to the seasons. They eat Japanese maple leaves fried in maple season, and there is a beach and typhoon season. They are very aware of climate change.

I loved the trip but I would like to have been there when it was cooler. We did swim in the Sea of Japan but it was too hot to be refreshing at the seashore. This past summer there were many heat waves. It was a wonderful trip but too short.

Area Events

Newbury

October 31 Roast Pork Dinner at South Newbury Union Church in the Friendship House at the Corner of Village and Sutton Roads at the blinking light.

MENU: Roast pork, mashed potatoes, gravy, coleslaw, rolls, coffee or tea and homemade desserts.

The Friendship House is handicapped accessible and takeouts are available. Another fabulous raffle basket will be available. For more info, Call 938-2064 or Joyce at 863-5431.

New London and Sunapee

October 25 Ausbon Sargent's 28th Annual Meeting at 3pm at the New London Historical Society, 179 Little Sunapee Road. Friends and members are welcome to attend. Refreshments to follow.

Warner

Volunteers Needed for Warner Festival

October 10 & 11 The 68th Warner Fall Foliage Festival. This festival is organized by a

dedicated board of directors and others. Each contributes hundreds of hours laying the groundwork for the festival but much more manpower is required to ensure this is a successful event. Volunteers are needed to help set up, clean up, sell raffle tickets, cook and serve food, park cars, assist vendors, remove trash and help with crowd control.

Each year the Warner Fall Foliage Festival has grown until it now attracts folks from as far away as Boston and Portland. This influx of people with their spending power directly improves the local economy and proceeds from the festival help support town projects, charities and organizations.

Anyone who is willing to donate a few hours during Columbus Day weekend is asked to complete the volunteer form on the festival website, wfff.org, or call 456-9775.



LAKE SUNAPEE BANK TO OPEN FULL SERVICE BRANCH IN CONCORD, NH

NEWPORT, NH – Lake Sunapee Bank is excited to announce that it will be opening a full service branch at 8 Loudon Road in Concord, NH. The new branch will be conveniently located just off I-93, in the same building as Convenient MD, next to Bed Bath & Beyond and Buffalo Wild Wings. With the addition of this new branch, Lake Sunapee Bank's banking network will now consist of 37 branch locations in seven counties throughout New Hampshire and Vermont.

Plans for the 3500 square-foot space include a progressive branch concept, incorporating technology and design to enhance the customer experience. The branch will offer a full range of retail banking services, as well as dedicated personnel for Commercial Banking, Business Banking and Mortgage Lending Services. In addition, the office will offer Insurance Services and Financial Planning Services.

Notice of Public Hearing

CAPITAL IMPROVEMENTS PROGRAM

7:00 PM Tuesday, October 13, 2015

Youth Room

Bradford Area Community Center

The Report is available for review at Town Office during regular hours at Brown Memorial Library and online at bradfordnh.org.

BRADFORD SEPTIC SERVICE LLC

- Septic Pumping
- Locate & Expose Covers
- Baffle Replacement
- Risers on Tank Covers

fast and friendly service

PO Box 391
Bradford, NH 03221

David Bagley
(603) 938-5033

OCTOBER CALENDAR

Thurs. October 1st

12 Noon Senior Dining
1:00 PM Mahjong Group

Fri. October 2nd

8:00 AM- 11:00AM Planning
Board Office
11:30 AM First Friday Brunch,
50/50 raffle & door prizes!
Call for reservations please!

Sat. October 3rd

9am - Noon Town Hall Restora-
tion Information Session, TH
9am - Noon TDS Fiberville pre-
sentation, TH grass

Mon. October 5th

8:45 AM Mt. View Sr. Ctr. Fitness
1:00 PM Bridge Group
4:00 PM Water Color Class

Tues. October 6th

10:00 AM Stitches from the Heart
Quilters
12 Noon Sr. Dining
1:00 PM Watercolor class

Wed. October 7th

4:00 PM Special Group #5 Youth
6:00 PM Yoga
7:00 PM Zoning Board

Thurs. October 8th

12 Noon Senior Dining
1:00 PM Mahjong Group
4:30 PM BACC/P&R Committees

Fri. October 9th

8:00AM- 11:00 AM Planning
Board Office
8:45 AM Mt. View Sr. Ctr. Fitness
1:00 PM Mahjong Group

Mon. October 12th

10:00 AM- 8:00 PM Library Open
8:45 AM Mt. View Sr. Ctr. Fitness
1:00 PM Bridge Group
7:00 PM Rural Heritage Connec-
tion

Tues. October 13th

10:00 AM Stitches from the Heart
12 Noon Senior Dining
5:30 PM Selectmen's Meeting
7:00 PM Planning Board

Wed. Oct. 14th

1:00 PM Knitting Group
6:00 PM Yoga
7:00 PM - Book Discussion, BML

Thurs. October 15th

12 Noon Senior Dining
1:00 PM Mahjong Group
5:30 PM Town Hall Restoration

Fri. October 16th

8:00 AM- 11:00 AM Planning
Board Office
8:45 AM Mt. View Sr. Ctr. Fitness
9:30- 11:30 AM Foot Care Clinic
at North Ridge
10:00 AM Movie: Age of Adaline,
PG-13
12 Noonish Senior Dining

Mon. October 19th

8:45 AM Mt. View Sr. Ctr. Fitness
1:00 PM Bridge Group
4:00 PM Water Color Class
6:30 PM- 8:00 PM - Chess, BML

Tues. October 20th

10:00 AM Stitches from the Heart
12 Noon Senior Dining
1:00 PM Watercolor class

Wed. October 21st

4:00PM Special Group #5
6:00 PM Yoga
6:30 PM Budget Committee

Thurs. October 22nd

12 Noon Senior Dining
1:00 PM Mahjong Group
7:00 PM Building Committee

Fri. October 23rd

8:00 AM- 11:00 AM Planning
Board Office
8:45 AM Mt. View Sr. Ctr. Fitness

Mon. October 26th

8:45 AM Mt. View Sr. Ctr. Fitness
1:00 PM Bridge Group
4:00 PM Water Color Class
5:30 PM Selectmen's Meeting

Tues. October 27th

9:30-11:30 LSVNA Foot Care at
Warner Pharmacy
10:00 AM Stitches from the Heart
12 Noon Senior Dining
7:00 PM Planning Board

Wednesday October 28th

10:30 -12 PM Blood Pressure
Clinic at Warner Senior Room
6:00 PM Yoga
7:00 PM Historical Society An-
nual Meeting, Tin Shop

Thurs. October 29th

12 Noon Senior Dining
1:00 PM Mahjong Group

Fri. October 30th

8:00 AM -11:00 AM Planning
Board Office
8:45 AM Mt. View Sr. Ctr. Fitness

Sat. October 31st

5:00 PM-7:00 PM - Trick or Treat
at the Library!
5:00 PM- 8:00 PM Spooky Din-
ner

*For the MVSC call Phil at
938-2104 with your ideas
or questions*

*To schedule rooms at the BACC
call Jim Valiquet at 938-2522*

Classified

FREE

Queen sized sleep sofa. Neutral
in color. 938-5281

All events take place at the Brad-
ford Area Community Center
(938-6228) or the Mountain View
Senior Center (938-2104) unless
otherwise noted. Please call to
confirm dates and times in case
there has been a change to the
submitted information.

Abbreviation Key

BACC-Bradford Area Community
Center
BBC-Bradford Baptist Church
BML-Brown Memorial Library
FGC-Fish & Game Clubhouse
Gillingham Drive
KAP-Kearsarge Area Preschool
KRES-Bradford Elemen. School
MVSC-Mountain View Senior Ctr
TH-Bradford Town Hall
ZBA-Zoning Board of Adjust.

Ongoing Events

Children's Storytime - Mondays 10am Pre-school, Wednesdays 10am Toddlers at BML
 Cemetery Commission - 2nd Thursday at 6PM Call 938-2119 for info
 Conservation Commission - 3rd Tuesday at 7PM, BML
 Fish and Game Club - 1st Tuesday 7PM at Fish and Game Club
 First Friday Bunch - 11:30AM at MVSC, reservations appreciated
 call 938-2104 for info
 Historical Society - Tin Shop, East Main Street, open Saturdays from 10am-noon
 May-October or by appointment. Please call 938-2078.
 Library Trustees - 1st Wednesday at 6:00PM BML
 Planning Board - 2nd and 4th Tuesday at 7PM, BACC
 Rural Heritage Connection - 2nd Monday, 7PM, BACC
 Selectmen's Meeting - Every Monday 5:30PM, BACC
 Zoning Board - 1st Wednesday, 7:00PM, BACC

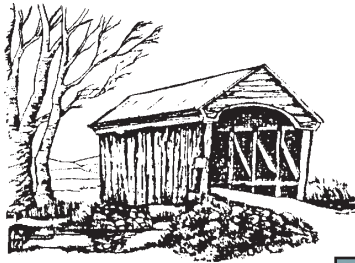

How Far Do We Go?

All the way to Provincetown, MA!



George Beaton reading the September issue of The Bradford Bridge in Provincetown, MA.

We are wondering how far afield the Bridge is read, in print and online. Send us a picture of some far away place the Bridge has reached so we can prove that we are just as good as the New York Times. Send photos to contact.us@BradfordBridge.com.

Get in the spooky spirit and visit the Bradford Historical Society this month. We are open on Saturday mornings from 10 am to noon through Columbus Day. Also, our Annual Meeting will be held on Wed. Oct 28th at 7pm and all are welcome. We have been working hard on developing a major site plan to include future buildings and insure that our meetings will be handicap accessible in the near future. And, best of all, the Good Witch will be handing out the biggest candy bars in town, so stop by on Halloween....if you dare!



Available for casual dining Tuesday - Sunday
The Appleseed Restaurant and Catering We're Affordable!
 Tuesday - Friday, 5:00-9:00 PM, Saturday and Sunday, 4:00-9:00 PM and
 Sunday Morning Brunch from 8:00 am-Noon. We buy local, hire local, and support local organizations
 Celebrating our 35th year of business in Bradford
Our Sunday Breakfast Buffet is a great way to start the week! 8am-noon \$9.99 pp
 Check out our restaurant at **938-2100**
www.appleseedrestaurant.com



Henniker Veterinary Hospital
 Professional Association

Small Animal & Equine Practice

Alyssa J. Brust, DVM
 Robert A. Brust, DVM
 Amy Jones, DVM
 Samantha Mazzucola, DVM

House Calls Available
428-3441
 Maple Street, Henniker

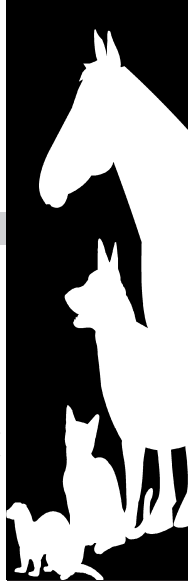

WALCO MECHANICAL CO.
 REFRIGERATION, HEATING,
 AIR CONDITIONING,
 ELECTRICAL CONTRACTORS
 COMMERCIAL • INDUSTRIAL • RESIDENTIAL
 SERVICE • SALES • INSTALLATION
 MAINTENANCE PROGRAMS
 SYSTEM EVALUATIONS
938-2926

Dockside Hair Design
 Full Service Salon

Jenny Wright
 Creative Stylist

BRADFORD POST OFFICE PLAZA
(603) 938-0090

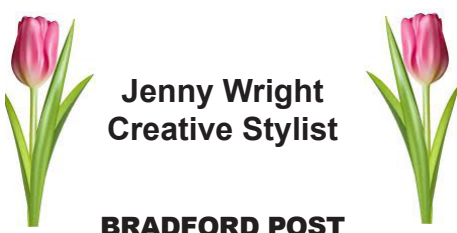

Library Lantern

by Meg Fearnley

NH 1000 Books Before Kindergarten. The library is participating in a new initiative called “NH 1000 Books Before Kindergarten” that encourages families to read to their young children and use the resources of their public library. The more you read to your children, the more prepared and eager they will be when it comes time for them to read independently. 1000 books may seem like a large number, but if you read one story a day to your child, you can complete 365 in one year. After reading 100 books, bring in your reading log and receive a sticker and a new tally sheet. After reading 1000 books participants will receive a free book! Come in the the library to pick up your tally sheet and more information about this great program.

Columbus Day. The library is open on Monday, October 12 from 10am until 8pm.

Book Discussion. Join us on Wednesday, October 14 at 7pm as we talk about the novel “The Illusion of Separateness” by Simon Van Booy. The book is a poetic and optimistic story of how we are all interconnected.

Chess. This month's chess night is on Monday, October 19 from 6:30 until 8:00pm.

In case you missed it, September 27 through October 3 is Banned Books Week, an annual celebration of the freedom to read. Exercise your freedom and check out books and other materials for free at your local library.

The top ten most frequently challenged books of 2014 are:
The Absolutely True Diary of a Part-Time Indian, by Sherman Alexie
Persepolis, by Marjane Satrapi
And Tango Makes Three, Justin Richardson and Peter Parnell
The Bluest Eye, by Toni Morrison
It's Perfectly Normal, by Robie Harris
Saga, by Brian Vaughan and Fiona Staples
The Kite Runner, by Khaled Hosseini
The Perks of Being a Wallflower, by Stephen Chbosky
A Stolen Life, Jaycee Dugard
Drama, by Raina Telgemeier



Some of the new books added to the library in September:

Adults

Purity / Jonathan Franzen
The Road to Character / David Brooks
Make Me / Lee Child
After You / Jojo Moyes
Fastest Things on Wings / Terry Masear
Between the World and Me / Ta-Nehisi Coates

Children and teens

Hit count / by Chris Lynch
Waiting / Kevin Henkes

Library Hours
 Monday, 10-8
 Wednesday, 10-7
 Saturday, 10-3
 Sunday, 11-3

Bradford Parks and Rec News

by Margaret L. Raymond

Bradford Parks & Rec., (along with the Bradford Area Community Center and the Friends of the Bradford Area Community Center), is working on putting up an ice skating ring on the "Old Naughton Property" out behind the Bradford Area Community Center. We are very excited about this and have several new people who have joined our committee to work on this.

Our mission this year is to get the skating rink up and usable. Fortunately for us there is an existing foundation on the property that will be used for the rink itself. We are also interested in having some kind of storage shed/snack shack/warming area. We are checking on where the water is on the property and have been in touch with Eversource about bringing the electricity to the rink for lighting.

Our main goal for this rink is to be able to provide an area for everyone, "children of all ages" who want to skate. In the future we are looking to be able to provide a space for ice hockey leagues to hold events.

If you haven't seen the area we're talking about, you really should check it out. This is town property and there is a large cleared area where many events could take place in the future. Some of the things we have talked about are disc golf, a nice park area with a pavilion where families and friends could gather for picnics, parties, cook-outs and all kinds of outdoor games.

We are looking for more people to bring forward their ideas and help carry this through. We are looking for donations of all kinds, time, services, money, skating equipment, people to maintain the area, equipment to maintain the ice, people to build things , people interested in advertising and fundraising. We want businesses, families, etc. to advertise on our site.

This project is for the town of Bradford and the surrounding area and we are hoping to get many people involved. This is only the beginning. Please join us!!

Our regular monthly meetings are the 2nd Thursday of the month at the Bradford Area Community Center, 5:00 pm. For more information, please call Margaret L. Raymond, Parks & Rec., 938-5392.

**TOWN HALL UPDATE
SATURDAY, OCTOBER 3rd
9:00AM - 12:00PM
on the BACC LAWN**



Interested in learning more about the current plans for our historic Town Hall building? The Town Hall committee cordially extends an invitation to all Bradford residents to visit the BACC on Saturday, October 3rd. Architectural plans for the building, as well as financial and fundraising information will be provided. All points of view are welcome and residents are encouraged to come with any questions and/or suggestions they may have. Light refreshments will also be available.



Local Author's Night

Local Author's Night in Bradford recently featured an eclectic mix of genres presented by (left to right) Thom Smith, Nate Herrick, Martha Von Redlich, and Maralyn Doyle. From true tales of life abroad, to romantic adventures set in medieval times, to cartoons of local landmarks, to pensive poetry...the audience was both entertained and inspired by the talents and diligence of these budding authors. The event was sponsored by the Friends of Brown Memorial Library.

Current Use Land in Bradford

The following is a condensed version of Chapter 16 of the Bradford Natural Resources Inventory. The complete text is located on the Bradford Conservation Commission's website at <http://bradfordnh.org/documents/BradfordNRI.pdf>

"It is hereby declared to be in the public interest to encourage preservation of open space, thus providing a healthful and attractive outdoor environment for work and recreation of the state's citizen's, maintaining the character of the state's landscape, and conserving the land, water, forest, agricultural and wildlife resources."

- NH Current Use law RSA 79-A
(enacted July 1, 1973)

The Current Use Assessment system is the cornerstone of the state's land conservation efforts, with over half the land in New Hampshire enrolled in this valuable program. Current Use provides a wide variety of benefits for landowners, municipalities, the State and the general public.

The Current Use system bases property tax on the 'current use' of the land and not as it had been, on its development potential. This program has enabled many landowners to afford to keep their land in traditional uses rather than convert to house lots and commercial development. It provides a property tax incentive to all qualifying landowners who agree to maintain their land in an undeveloped condition. This assessment is based on the capacity of the land to produce income in its current use.

'Cost of Community Services' studies throughout the state have demonstrated that undeveloped land sends more tax income to the town than they use in services (such as schools, fire and rescue, etc.) even at the lower tax rate provided by the Current Use program. They thus have a positive effect on the tax rate compared to residential housing which nearly always requires more in town services than is realized in its property tax payments.

When land is changed from 'open space' land to other uses, a penalty tax is paid to the town as compensation for previous tax reductions. In 1992, the town voted to give half of this penalty fee to the town's Conservation Fund to be used for protection of remaining valuable open space land in town. The other half is deposited in the town's general fund.

Saint Michael's College, Vermont Dean's List

Owen O. Dayton, son of Bliss and Mary Keegan- Dayton of Bradford, a senior, Accounting major. He is a graduate of Kearsarge Regional High School.

Mary-Margaret L. Pickman, daughter of Jane Lucas and James Pickman of Bradford, a sophomore, American Studies and Elementary Education major and a graduate of Kearsarge Regional High School.



**Belanger Roofing,
Painting & Home
Repairs**
Light Masonry
Specializing in Benjamin Moore Oil
Paints and Restoration
Serving Bradford 20 years
Call John 938-2858
EPA Lead Certified

Brackett L. Scheffy Counselor At Law

General Practice of Law Including:

Estate Planning--Wills, Trusts, Powers of Attorney
and Probate Avoidance
Estate Administration
Real Estate and Contract Matters

PO Box 285, Bradford, NH 03221

938-5600

Bradford Bog Boardwalk Repair Day

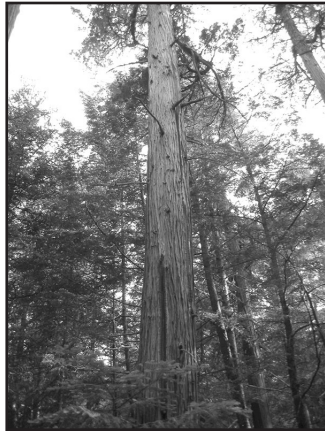

How can it be? It's that time of year; time for the annual Bog Boardwalk repair day. Every year at least forty hemlock boards are carried out to replace boards that got tired of the winters, the moose, and just living in a damp environment.

What? You say you've never been out to the Bog? It's located on East Washington Road, just over three miles from its intersection with West Road – on the left just before the town line. The Bog consists of an unusual Atlantic white cedar swamp that expands to a quaking bog that has its own specific set of plant life. There is an observation platform at the end of the boardwalk overlooking the fall colors of the wetland. For those interested in history, there is the small park with informational signage where the Bradford Springs Hotel once stood.

Repair Day begins at 9am on Sunday, October 18th with a rain/snow day of the following Sunday, October 25th. Wear sturdy shoes – the boardwalk is level but slippery when wet. A pair of loppers would be useful and gloves quite essential. Refreshments will be served! Sponsored by the Bradford Conservation Commission.



LOCAL HIKING TRAILS NEED YOUR HELP !!



Go to www.srkg.org & Facebook for SRK Greenway Coalition info!

CONTACT leader for meeting Time & Place; SRKG Trail Guide book sold locally

Oct 4 (Sun): Easy hike in Springfield from Baptist Pond to NH 114 via Star Lake Farm. 4.1 miles on town and abandoned roads. **Contact:** Lee Carvalho 7355719 or leecarvalho6@gmail.com

Oct 10 (Sat): Hike from Mt Sunapee SP to Sunapee via Webb Woods, and Red Water Creek and Riverwalk. Moderate 7.3 miles. **Contact:** Nathan Richer Ph 763-2127 or <nricher@ruger.com>

Oct 17 (Sat): Hike SRKG from Great Brook in New London. Easy 3.2 miles passing cellar holes and Webb Forest. **Contact:** Rosanna Dude Ph 828-1001 or <rosannaleigh@gmail.com>

Oct 24 (Sat): Learn and build: trail maintenance skills -- water diversion, root control, path definition -- with expert instructor Lew Shelley, formerly a national crew trainer for Student Conservation Association. On SRK Greenway's Fishersfield Trail in Newbury. Tools provided. **Contact:** <trails@srkg.org> or Gerry Gold Ph 526-2857.

Oct 25 (Sun): Hike Mount Sunapee on SRKG Trail 1 from Newbury passing Lake Solitude,. 5.4 miles with steep ascent. **Contact:** George Beaton Ph 938-2637 or <kimbalowe@gmail.com>

Quabbin-to-Cardigan Partnership (q2cpartnership.org)
& Meadowsend Timberlands Ltd (mtlforests.com) in New London
Support the SRK Greenway volunteers who keep our hiking trails healthy



THE BRADFORD HISTORICAL SOCIETY

**HALLOWEEN AT THE TIN SHOP
 SATURDAY, OCTOBER 31st
 3PM-7PM**

**COME VISIT THE TIN SHOP ON E. MAIN ST. FOR HALLOWEEN TREATS.
 CREATIVE COSTUMES AND ALL AGES WELCOME!**



**The Tin Shop
 160 East Main St.
 Bradford, NH**

Obituaries



Stephen M. Olson, Sr, 37, of Bailey Road, South Sutton, died Sept. 9, 2015 at his home. He was born in Portsmouth on March 2, 1978. Steve spent his early years in Exeter and graduated from Exeter High School. He attended the NH Police Academy and served as Police Officer for the Town of Bradford for 11 years.

He was happiest spending time with his family and especially enjoyed flying drones and practicing archery with his son, Stephen, Jr.

Members of his surviving family include his wife of nine years, Sheri Olson; his 6-year old son, Stephen Michael Olson, Jr. and stepson, Zach Swinerton all of South Sutton; his mother, Sue Moulton of Hampton; his sister, her husband and family, Melissa and Steve Jautaikis, Alex and Jamison all of Exeter; his brother and his family, Jimmy and Michele Fliopp, Annie and Sammy of Austin, TX; Sheri's family, Carl and Gail Olson and Ken, Tobyn and Paige Olson; aunts and uncles and his best friend, Rich Bowen who has been loyal and supportive to Steve and the family.

A service will be held in Hampton at a later date. Memorial

contributions may be made to Stephen M. Olson Jr., c/o Lake Sunapee Bank, P.O. Box 37, New London, NH 03257.

Henry M. Shea Jr, 85 of Plaistow died Sept. 3, 2015 at Exeter Hospital.

He was born, Aug. 22, 1930 in Haverhill, MA, the son of the late Henry M. and Jessie N. (Merrill) Shea. He was raised and educated in Haverhill and graduated from the Haverhill Trade School, Class of 1949.

Henry worked for Brentwood Furniture in Haverhill, as a production supervisor for 35 years. He owned and operated Shea's Colonial Furniture in Plaistow from 1958 to 1986.

Henry is survived by his wife of 64 years, Elizabeth J. "Betty" (Richard) Shea of Plaistow; a daughter, his brother and his wife, a sister and numerous grandchildren, including Jennifer E. Richardson of Bradford, a great granddaughter, and many nieces, nephews, and cousins.

Burial was in St. James Cemetery in Haverhill. Donations may be made to the charity of one's choice. Please visit: brooksidechapelfh.com to sign an online guest book.



Nancy W. Nancy W. Betz of Twin Lakes Community, Burlington, NC, died Sept. 7, 2015. She was born in Scranton, PA, July 21, 1933, to Owen and Anne Williams. Nancy married Fredric J. Betz in 1955 and together they had three children, Fredric O. Betz (Anne), of Fredericksburg, VA, Charles J. Betz of Warner and Natalie B. Miles (Tim) of Haw River, NC. They also enjoyed their five grandchildren, including Frederick and Carl of Bradford.

Nancy was preceded in death by her parents, siblings and husband. Nancy was her high school valedictorian and a graduate of Bloomsburg State Teachers College, where she was a member of Who's Who in American Colleges. She taught elementary school and remedial reading.

Charles "Charley" E. Hosmer, 77, of Newell Road, died July 29, 2015, at the New London Hospital surrounded by his family.

He was born in New London, on Aug. 8, 1937, the son of George H. and Hazel (Nye) Hosmer, Sr. Spending his early years in Sutton, he graduated from New London High School in 1955 and moved to Newbury after he was married.

A harder worker, one will never find. Charley was dedicated and committed and meticulous in everything he did. He worked on wood, driveways, plowing and

Obituaries (continued)

anything else you could possibly need done. His work ethic was above and beyond.

Charley enjoyed maple sugaring. He was a lifetime member of the Blaisdell Lake Protective Association and an honorary member of the Sutton Historical Society.

He is predeceased by a brother, George H. Hosmer Jr. and a sister, Elizabeth Frew. Members of his surviving family include his wife of 58 years, Veda (Whipple) Hosmer of Newbury; two daughters, Debra Hosmer of Sutton and Elizabeth A. and her husband, Christopher Seufert of Ft. Myers, FL; two grandchildren, Nicole and her husband, Christopher Cable of San Tan Valley, AZ, and Eric Seufert of Phoenix, AZ; and two great-grandchildren, Andrew and Lauren Cable of San Tan Valley, AZ.

Burial was in Millwoods Cemetery, South Sutton. Memorial contributions may be made to the Blaisdell Lake Protective Association, PO Box 453 or the Sutton Historical Society, PO Box 457, both South Sutton, NH 03273. To sign an online guestbook please visit chadwickfuneralservice.com.

'Silent Tear' by Anon

*Each night we shed a silent tear,
As we speak to you in prayer.
To let you know we love you,
And just how much we care.
Take our million teardrops,
Wrap them up in love,
Then ask the wind to carry them,
To you in heaven above.*

John C. Duffett, 87, died suddenly Aug. 25, 2015, at Elliot Hospital after a short period of failing health. He was born Oct. 1, 1927, in Concord, to Thomas and Mary (Ledrew) Duffett. He grew up in Concord, graduated in 1945 from Concord High School and served in the U.S. Coast Guard as a seaman during World War II. He earned a bachelor's degree in electrical engineering from the University of New Hampshire in 1951, then entered the U.S. Air Force upon graduation and served as a First Lieutenant during the Korean War on an island off Okinawa.

John married Jean Holmes of Henniker in 1953. He was employed as an engineer for IBM in Newton, MA, and then for Public Service Company of New Hampshire, Manchester. Over the next 36 years he served in a number of management positions for PSNH retiring in 1990 as president, CEO and chairman of the PSNH Board of Directors. He was a Registered Professional Engineer and member of the Institute of Electrical and Electronic Engineers.

He enjoyed woodworking, making many tables and other items, and rebuilding the family cottage at Lake Massasecum in Bradford, where he spent many enjoyable summers. After retiring, he spent relaxing winters in Siesta Key, FL

Surviving family members include his loving wife of 62 years, Jean; daughter, Joan Bennett and her husband, Dick, of Manchester; son, Steven Duffett and

his wife, Paulette, of Dover, MA; daughter, Linda DeMeo and her husband, John, of Cary, NC; his grandchildren; his sister, Elizabeth Horton and her husband, Edward of Brookline, MA; and many nieces and nephews. He was predeceased by his sisters, Doris Cushing, Vida Everett, Jessye Clark, Ellie Smith and Nancy Strong and brothers, Herbert and Thomas Duffett.

Donations may be made in memory of John Duffett to the Boys & Girls Club of Manchester, 555 Union St., Manchester, NH 03104.

Elizabeth "Marcy"

Conkey passed peacefully at TideWell Hospice House in Englewood, Fl. She was born on December 29, 1936 in Providence, RI to Dennis and Mary (nee Lavin) Healey of Roscommon, Ireland.

Marcy is survived by her husband of 60 years, Guy, a sister, Catherine Moretta of Rhode Island, a brother, John Healey of Rhode Island, and by her children Raymond of Ok., Joe of Mass., Christopher, of Mass., Stephen of NC. and Kathleen (Bradford, NH). She is survived by her grandchildren, Elizabeth, Lindsey, Matthew, Caroline and Alex as well as three great-grandchildren.

In memory of Marcy, contributions can be made to TideWell Hospice House, 12034 N. Access Rd., Port Charlotte, FL., 33981.

New Library Exhibit

The Bradford Art Group opened a new exhibit in Brown Memorial Library: Anne B. Corbett, Photographs that will continue into January, 2016.

Anne is a wife, mother, and by her own admission, a proud grandmother. She and her husband live in Croydon. She started taking photographs for her high school's yearbooks with a Kodak Brownie camera. After high school, most of her photography was of family or on trips. She bought

her first Single Lens Reflex camera during an extended trip through Fiji in the South Pacific. She and her husband volunteer for the Sunapee Fire Department as incident photographers. She has exhibited her work at the Library Arts Center in Newport and Howe Library in Hanover.

In the Bradford exhibit, the collection includes images of birds (loons a speciality) and landscapes. She writes: "I enjoy the freedom digital

photography allows, no longer worrying about the confines of film and the darkroom. It gives me more chance to experiment and explore...." With the help of her daughter, Anne continues her education, learning computer programs.

The handicapped-accessible Brown Memorial Library is located at 78 West Main Street, Bradford, NH. Library hours: M. 10 - 8; Wed. 10 - 7; Sat. 10 - 3; Sun. 11-3. For more information, call 938-5562.

THE KIDS Bridge October



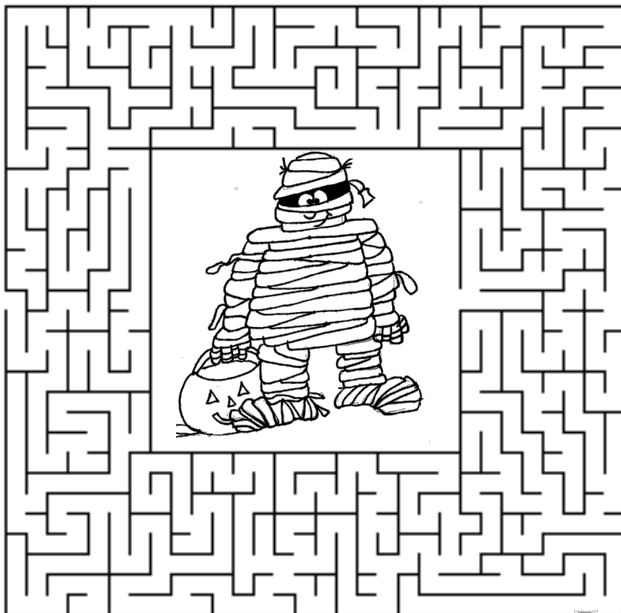

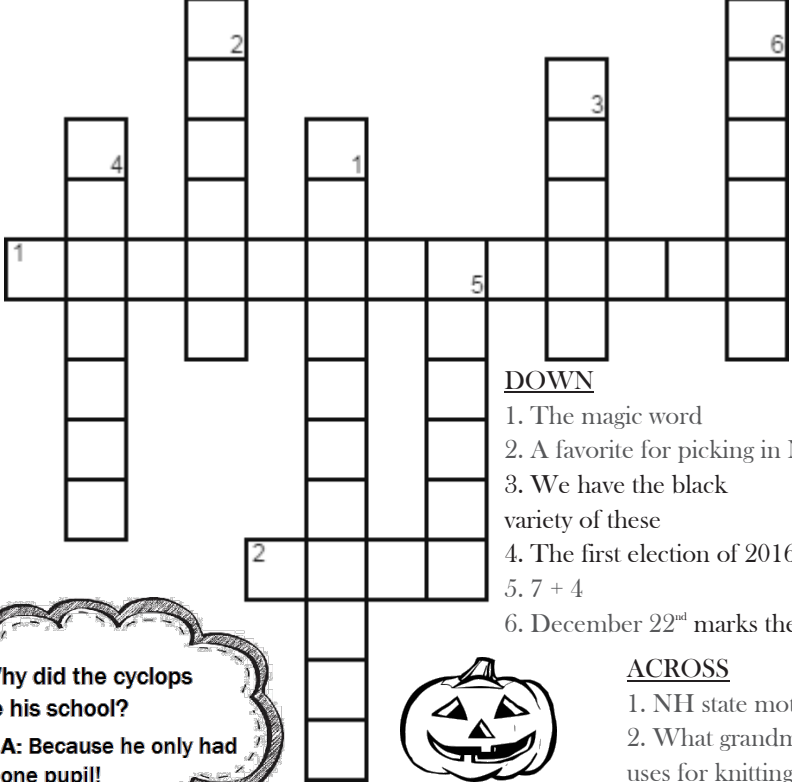

DOWN

1. The magic word
2. A favorite for picking in NH
3. We have the black variety of these
4. The first election of 2016
5. 7 + 4
6. December 22nd marks the start

Q: What's worse than being a 5-ton witch?

A: Being her broom!

Q: Why did the cyclops close his school?

A: Because he only had one pupil!



(Check back in November for the answers!)